

OFICINAS - C.M.P.

MONSANTO

PINTO

DE SOUSA

RUA

DE

DE

RUA

n



ESC. 1:500

BAIRRO DO CARVALHO - C.M.P.

VEREDAS E ARRUMAMENTOS - ESTADO ACTUAL

18. Abril. 1969 - *Flumen*

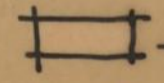
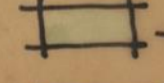
J. L. S. Lourenço 25/4/69

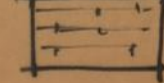
-  - BLOCOS
-  - CANTEIROS
-  - CAMINHOS DE PÉ POSTO
-  - EXTENSÕES

OFICINAS - C.M.P.

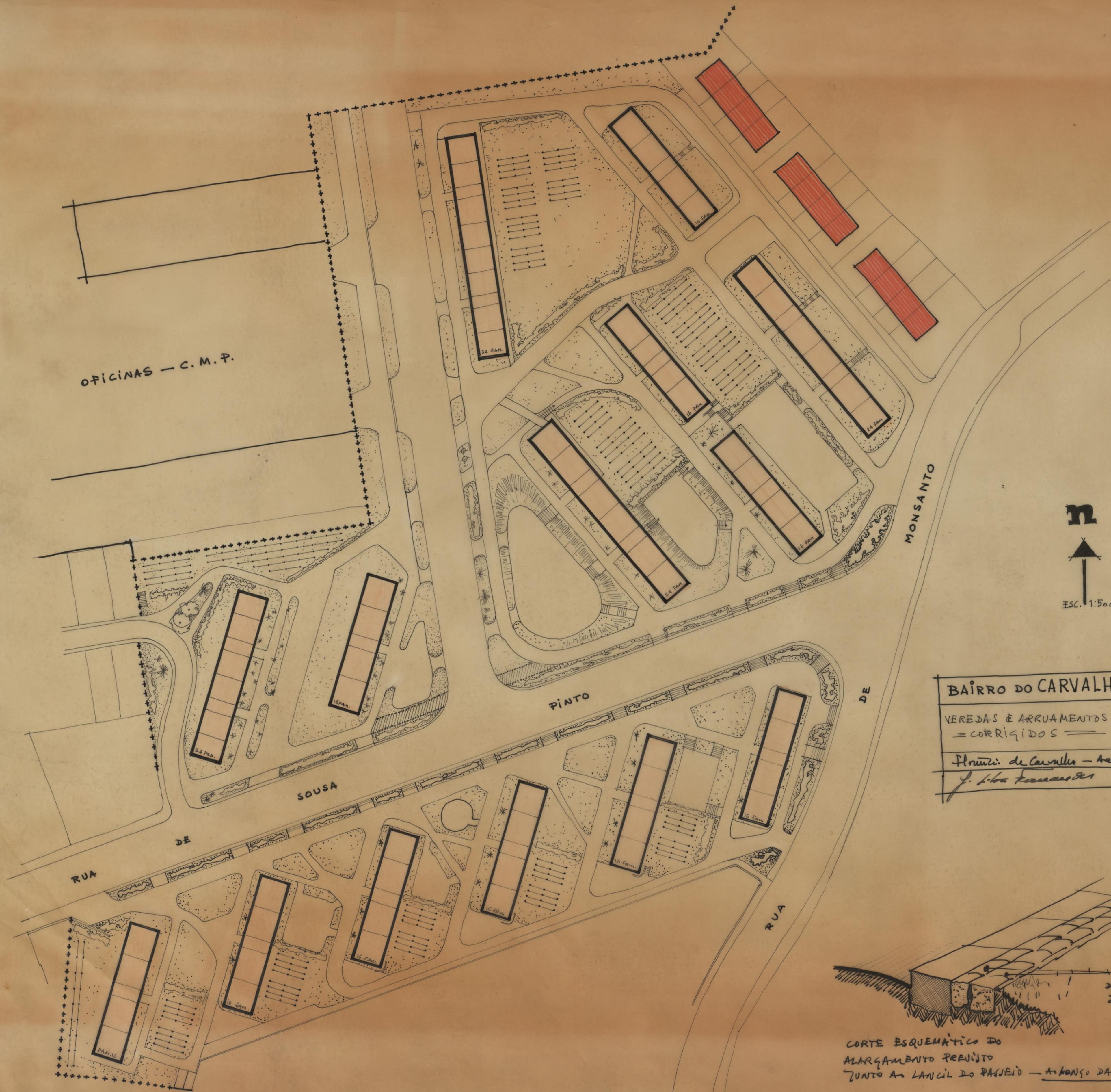

BAIRRO DO CARVALHIDO = C.M.P.	
VEREDAS E ARRUAMENTOS = CORRIGIDOS	ALTERAÇÕES PROPOSTAS
Fluência de Carvalho - Aeq.	23.IV.1969
J. L. Fernandes	25.IV.69

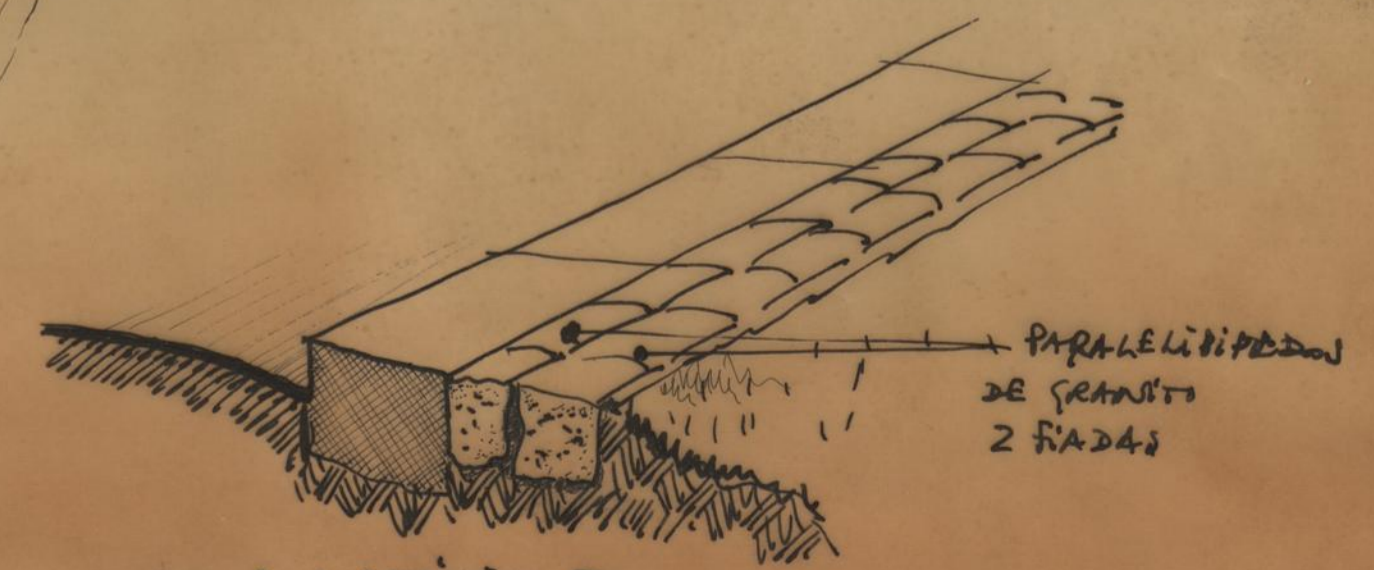

CORTE ESQUEMÁTICO DO ALARGAMENTO PREVISTO JUNTO AO LANCIL DO PARQUEÍO - ANEXO DA R. SOUSA PINTO